

GOVERNMENT OF MAHARASHTRA

DETAILED ESTIMATE

Detailed Estimate for the Work of

Construction of Vegetable dehydration  
processing plant Shed for Parashara Krishi  
Farmer Producer Company Ltd. at Tq.  
Phulambri, Dist. Aurangabad.

Estimated Cost Rs. 99,98,144.00

Name of Work :- Construction of Vegetable dehydration processing plant Shed  
for Parashara Krishi Farmer Producer Company Ltd. at Tq. Phulambri, Dist.  
Aurangabad.

## Index

Sr.No.	Particulars	Page From	Page To
1	Fund Head Sheet		
2	General Report		
3	Recapitulation Sheet		
4	Abstract		
5	Measurements		
12	Rate Analysis		
13	Lead Chart		
14	Quarry Chart		
15	Trial pit		
16	Working Drawing		

Name of Work :- Construction of Vegetable dehydration processing plant Shed for Parashara Krishi Farmer Producer Company Ltd. at Tq. Phulambri, Dist. Aurangabad.

## Fund Head Sheet

OFFICE

JV STRUCTURAL ENGINEERS AND  
CONSULTANT AURANGABAD

SANCTIONED ESTIMATE NO.

FUND HEAD

MAJOR HEAD

MINOR HEAD

SERVICE HEAD :

DEPARTMENTAL HEAD :

Estimate framed for the probable expenses that will be incurred for the work of **Construction of Vegetable dehydration processing plant Shed for Parashara Krishi Farmer Producer Company Ltd. at Tq. Phulambri, Dist. Aurangabad.**

Total Cost of work : 99,98,144.00

Administratively approved under  
No.

Estimate prepared by :

Estimate Checked by :

*GENERAL REPORT*

.....Attached Separately.....

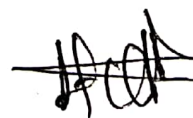
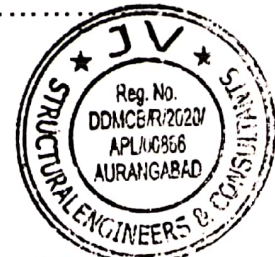
JV STRUCTURAL  
ENGINEERS AND CONSULTANT  
AURANGABAD

Name of Work :- Construction of Vegetable dehydration processing plant Shed for Parashara Krishi Farmer Producer Company Ltd. at Tq. Phulambri, Dist. Aurangabad.

## Fund Head Sheet

OFFICE

JV STRUCTURAL ENGINEERS AND  
CONSULTANT AURANGABAD

SANCTIONED ESTIMATE NO.

FUND HEAD

MAJOR HEAD

MINOR HEAD

SERVICE HEAD :

DEPARTMENTAL HEAD :

Estimate framed for the probable expenses that will be incurred for the work of **Construction of Vegetable dehydration processing plant Shed for Parashara Krishi Farmer Producer Company Ltd. at Tq. Phulambri, Dist. Aurangabad.**

Total Cost of work : 99,98,144.00

Administratively approved under  
No.

Estimate prepared by :

Estimate Checked by :

*GENERAL REPORT*

.....Attached Separately.....

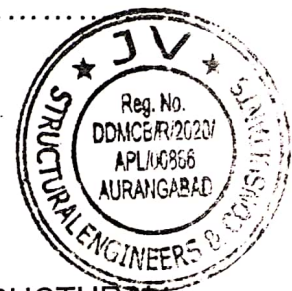

JV STRUCTURAL  
ENGINEERS AND CONSULTANT  
AURANGABAD

Name of Work :- Construction of Vegetable dehydration processing plant Shed for Parashara Krishi Farmer Producer Company Ltd. at Tq. Phulambri, Dist. Aurangabad.

## General Report

1. Name of work :- Construction of Vegetable dehydration processing plant Shed for Parashara Krishi Farmer Producer Company Ltd. at Tq. Phulambri, Dist. Aurangabad.

Following provisions are made in the estimate.

- 1) RCC framed structure with open foundation.
- 2) Providing soling using 80 mm size Below Footing & Flooring Only
- 3) Providing and laying P.C.C. M-10 For Flooring & M15 For Footing, Coping
- 4) Providing and laying R.C.C. M-20 For Footing, Column, Beams, Chajja .
- 5) Providing Second Class Burnt Brick Masonry for All Internal & External Walls.
- 6) Providing internal cement plaster 12mm with neeru finish & External Sand faced plaster.
- 7) Providing and laying Kotha Stone Flooring For All Flooring
- 8) Providing and applying washable oil-bound distemper For Internal walls
- 9) Providing and applying 3 Coats Water Proofing Cement paint For External Side
- 10) Providing and fixing rolling shutter.
- 11) Ventilator are provided above the Lintel Level.

The rates are adopted as per State -E- SSR 2021-22 and nearest quarry is adopted for material.

So early technical sanction to the estimate is requested please.



JV STRUCTURAL  
ENGINEERS AND CONSULTANT  
AURANGABAD

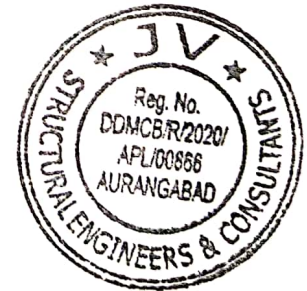

Name of Work :- Construction of Vegetable dehydration processing plant Shed  
for Parashara Krishi Farmer Producer Company Ltd. at Tq. Phulambri, Dist.  
Aurangabad.

**Recapitulation Sheet**

Sr. No.	Perticulars	Amount As per Estimate
<b>A</b>		
1	Cost of Vegetable Shed ( 30.00m x 30.00m )	88,35,550.00
2	Cost of Royalty Charges	46,420.00
3	Cost of Quality Control Charges	11,730.00
<b>Total (A)</b>		<b>Rs. 88,93,700.00</b>
4	Add 12% for G.S.T. Charges (on-1)	10,60,266.00
5	Add 0.50% for Labour Insurance Charges (on-1)	44,178.00
<b>Total Cost of Construction</b>		<b>99,98,144.00</b>
<b>Say in Lakh = 99.98</b>		

**JV STRUCTURAL  
ENGINEERS AND CONSULTANT  
AURANGABAD**



Name of Work :- Construction of Vegetable dehydration processing plant Shed for Parashara Krishi Farmer Producer Company Ltd. at Tq. Phulambri, Dist. Aurangabad.

Abstract Sheet

Item No.	Item Of Work.	Qty.	Rate	Unit	Amount
1	<p><b>Excavation</b> Excavation for foundation in earth, soil of all types, sand, gravel and soft murum, including removing the excavated material up to a distance of 50 m. beyond the building area and stacking and spreading as directed, dewatering, preparing the bed for the foundation and necessary back filling, ramming, watering including shoring and strutting etc. complete. (Lift upto 1.5 m.) By Mechanical Means. Bd.A.1 Page 1 Number 259. SSR I.No. 21.02, Sr.No.721, P.No.153</p>	231.570	207.00	Cum	47935.00
2	<p>Filling in plinth and floors with contractors material/brought from outside and approved by Engineer incharge in layers of 15 cm to 20 cm including watering and compaction etc. complete.. Spec. No. Bd.A.11 Page 1 Number 263. SSR I.No. 21.37, Sr.No. 751, P.No. 157</p>	214.730	818.98	Cum	175860.00
3	<p>Providing soling using 80 mm size trap metal in 15 cm. layer including filling voids with Crushed sand/grit, ramming, watering etc. complete.. Spec. No. As directed by Engineer in charge. SSR I.No. 21.40, Sr.No. 754, P.No. 157</p>	130.890	2048.34	Cum	268107.00
	<p><b>Plain Cement Concrete</b> Providing and laying Cast in situ/Ready Mix cement concrete in M-10 of trap/ granite/ quartzite/ gneiss metal for foundation and bedding including bailing out water, Steel centering, formwork, laying/pumping, compacting, roughening them if special finish is to be provided, finishing if required and curing complete, with fully automatic micro processor based PLC with SCADA enabled reversible Drum Type mixer/concrete Batch mix plant (Pan mixer) etc. complete. With fine aggregate (Crushed sand VSI Grade) Spec. No. Bd.E.1 Page 1 No. 287.SSR I.No.24.01, Sr.No.827, P.No.175</p>	87.260	6430.83	Cum	561154.00

Item No.	Item Of Work.	Qty.	Rate	Unit	Amount
5	Providing and laying Cast in situ/Ready Mix cement concrete in M15 of trap/ granite/quartzite/gneiss metal for bed blocks, foundation blocks and such other items including bailing out water, Steel centering, formwork, laying/ pumping, compacting, roughening them if special finish is to be provided, finishing uneven and honeycombed surface and curing etc. complete. The Cement Mortar 1:3 plaster is considered for rendering uneven and honeycombed surface only. Newly laid concrete shall be covered by gunny bag, plastic, tarpaulin etc. (Wooden centering will not be allowed.), with fully automatic micro processor based PLC with SCADA enabled reversible Drum Type mixer/ concrete Batch mix plant (Pan mixer) etc. complete. With fine aggregate (Crushed sand VSI Grade) Sepc. No. Bd.E.4 Page Number 289 and B7, Page Number38. SSR I.No. 24.08, Sr.No. 830, P.176	21.870	6940.39	Cum	151786.00
6	Providing and laying in situ /Ready Mix cement concrete M-20 of trap / granite /quartzite/ gneiss metal for R.C.C. work in foundations like raft, strip foundations, grillage and footings of R.C.C. columns and steel stanchions etc. including bailing out water, Steel centering formwork, laying/pumping cover blocks, compaction and curing roughening the surface if special finish is to be provided (Excluding reinforcement and structural steel) etc. complete, with fully automatic micro processor based PLC with SCADA enabled reversible Drum Type mixer/ concrete Batch mix plant (Pan mixer) etc. complete. With fine aggregate (Crushed sand VSI Grade) Spec. No.Bd.F.3 Page 1 No. 298 and B.7, Page No.38. SSR I.No.25.11, Sr.No.836 P.No.178	48.380	7679.42	Cum	371530.00
7	Providing and laying Cast in situ/Ready Mix cement concrete M-20 of trap / granite /quartzite/ gneiss metal for R.C.C. columns as per detailed designs and drawing or as directed including steel centering, formwork, cover blocks, laying/pumping, compaction finishing the formed surfaces with cement mortar 1:3 of sufficient minimum thickness to give a smooth and even surface or roughening if special finish is to be provided and curing etc. complete.(Excluding reinforcement and structural steel).with fully automatic micro processor based PLC with SCADA enabled reversible Drum Type mixer/ concrete Batch mix plant (Pan mixer) etc. complete. With fine aggregate (Crushed sand VSI Grade) Spec. No. : Bd.F.5 Page No. 300 and B.7, Page.No. 38.SSR I.No.25.31, Sr.No.841, P.No.179	70.060	14358.42	Cum	1005951.00

Item No.	Item Of Work.	Qty.	Rate	Unit	Amount
8	Providing and laying Cast in situ/Ready Mix cement concrete M-20 of trap / granite /quartzite/ gneiss metal for <u>R.C.C. beams and lintels</u> as per detailed designs and drawings or as directed including steel centering, formwork, cover blocks, laying/pumping, compaction and roughening the surface if special finish is to be provided and curing etc. complete. (Excluding reinforcement and structural steel). with fully automatic micro processor based PLC with SCADA enabled reversible Drum Type mixer/ concrete Batch mix plant (Pan mixer) etc. complete. With fine aggregate (Crushed sand VSI Grade) Spec. No. :Bd.F.6 Page Number 300 and B.7, Page 1 Number 38 Page.No. 38.SSR I.No.25.50, Sr.No.846, P.No.181	20.840	12844.42	Cum	267678.00
9	Providing and fixing in position TMT - FE - 500 bar reinforcement of various diameters for R.C.C. pile caps, footings, foundations, slabs, beams columns, canopies, staircase, newels, chajjas, lintels, copings, fins, arches etc. as per detailed designs, drawings and schedules. including cutting, bending, hooking the bars, binding with wires or tack welding and supporting as required complete.. Spec.No. Bd.F.17, Page 1 No. 306. SSR I.No.26.33, Sr.No.871, P.No.188	13.450	89838.46	MT	1208327.00
10	Providing <u>structural steel work in trusses</u> , other similar trussed purlins and members with all bracing, gusset plates etc. as per detailed designs and drawings or as directed including cutting, fabricating, hoisting, erecting fixing in position, Making riveted/ bolted/ welded connection and one coat of anticorrosive paint and over it 2 coats of oil painting approved quality and shade etc. complete.Spec.No. Bd.C.8 Page Number 278 SSR I.No.23.04, Sr.No.819, P.No.173	14.400	119594.46	MT	1722160.00
11	Providing and <u>fabricating structural steel work in rolled sections like joists, channels, angles, tees etc.</u> as per detailed design and drawings or as directed including cutting, fabricating, hoisting, erecting, fixing in position making riveted / bolted /welded connections without connecting plates, braces etc. and including one coat of anticorrosive paint and over it two coats of oil painting of approved quality and shade etc. complete.. Spec. No. Bd.C.2 Page 1 Number 275 SSR I.No.23.01, Sr.No.816, P.No.173	11.600	101979.46	MT	1182962.00
<b>Brick Work</b>					
12	Providing <u>second class Burnt Brick masonry</u> with conventional/ I.S. type bricks in cement mortar 1:6 in <u>foundations and plinth of inner walls/</u> in plinth external walls including bailing out water manually , striking joints on unexposed faces, raking out joints on exposed faces and watering etc. Complete. Spec. No. As directed by engineer in charge and BDG- 2 and 5. SSR I.No.27.01, Sr.No.889 P.No.197	6.960	8452.90	Cum	58832.00

Item No.	Item Of Work.	Qty.	Rate	Unit	Amount
13	Providing second class Burnt Brick masonry with conventional/ I.S. type bricks in cement mortar 1:6 in superstructure including striking joints, raking out joints, watering and scaffolding etc. Complete Spec. No. Bd.G.5 Page One Number 315. SSR I.No.27.05, Sr.No.892 P.No.197	66.320	8691.90	Cum	576447.00
<b>Plastering &amp; Pointing</b>					
4	Providing sand faced plaster externally in cement mortar using approved screened sand, in all positions including base coat of 15 mm thick in cement mortar 1:4 using waterproofing compound at 1Kilogramper cement bag curing the same for not less than 2 days and keeping the surface of the base coat rough to receive the sand faced treatment 6 to 8 mm thick in cement mortar 1:4 finishing the surface by taking out grains and curing for fourteen days scaffolding etc.complete. Spec. No. : Bd.L.7 Page 1 No. 369. SSR I.No.32.11, Sr.No.963, P.No.209	515.520	652.53	Sqm	336392.00
<b>Oil Painting</b>					
5	Providing and applying three coats of water proof cement paint of approved manufacture and of approved colour to new plastered surfaces including scaffolding if necessary, cleaning and preparing the surface, watering for two days etc. complete. Spec. No. : As directed by Engineer in charge. SSR I.No.35.15, Sr.No.1085, P.no.224	515.520	104.00	Sqm	53614.00
6	Providing and applying two coats of synthetic enamel paint of approved colour to new /old structural steel work and wood work in buildings, including scaffolding if necessary, cleaning and preparing the surface (excluding primer coat) etc. complete. Spec. No. Bd.0.5 Page 1 No. 405..SSR I.No.35.07, Sr.No.1077 P.No.227	11.520	96.00	Sqm	1106.00
7	Providing and fixing rolling shutter fabricated from steel laths of minimum thickness 0.9 mm with lock plate of 3.15 mm thickness reinforced with 35 x 35 x 5 mm angle section fitted with sliding bolts and handles for both sides, deep M.S. channel section of depth and thickness not less than 65 mm and 3.15 mm respectively with hold fast arrangements, M.S. Bracket plate 300 x 300 x 3.15 mm minimum size and shape with square bar, suspension shaft of minimum 32 mm diameter, hood cover of M.S. sheet not less than 0.9 mm thickness and of any size at top and safety devices including mechanical gear operation arrangement consisting of worm gear wheels and worms of high grade cast iron or mild steel and one coat of red lead primer etc. complete. (I.S. 62481979) (With mechanical gear) Spec.No.: BD.V 5 page 551 and as directed by Engineer in charge. SSR I.No.39.25, Sr.No.1218, P.No.249	11.520	5443.46	Sqm	62709.00

Item No.	Item Of Work.	Qty.	Rate	Unit	Amount
18	Providing and fixing corrugated galvanised iron sheets of 0.63mm thick (24 B.W.G.) for roofing without wind tiles including fastening with galvanised iron screws and bolts, lead and bitumen washers as per drawing etc. complete.(Weight of 5.5 Kilogram/sq.m.). Spec.No.: Bd.R.5, Page One Number 453. SSR I.No.38.04, Sr.No.1144, P.No.233	900.000	870.00	Sqm	783000.00
19	Providing and fixing colour coated Zinalume ( R ) AZ150 ( min 150 gms/sq.mt. total on each side profiled sheets for roofing. The feed material is manufactured out of nominal 0.45 mm Base Metal Thickness BMT ) (0.5 mm TCT ), Hi-strength steel with min.550 MPa yield strength, metallic hot dip coated with Aluminium-Zinc alloy (55% aluminium 43.4% zinc 1.6% silicon) with COLORBOND ( R ) steel quality super durable polyester paint coat ( with inorganic pigment). The paint shall have a total coating thickness of nominal 35 um, comprising of nominal 25 um exterior coat on top surface and nominal 10 um reverse coat on back surface. Profile sheet shall have nom. 950-1050 mm effective cover width and nominal 25-30 mm deep ribs with subtle square fluting in the five pan at nominal 180-250 mm center- to-center. The end rib shall be designed for anti-capillary groove. and return leg. The feed material should have co-manufacturers product details marked at a regular interval. Including fasteners with min. fastened with min. 25 um Zinc-Tin alloy coated, Hex head, self-drilling screw etc. complete. (weight of profile 4.52 Kilogram/Square Metre)Spec. No. As directed by Engineer in Charge SSR I.No.38.34, Sr.No.1174 P.No.236	0.000	1173.00	Sqm	0.00

<b>Total Cost Of Proper Building (A)</b>	=	<b>8835550.0</b>
--	---	------------------

0	Royalty Charges-as per statement attached				
	For Sand	0.000	237.37	Cum	0.00
	For Murum	214.730	216.18	Cum	46420.00

<b>Total Cost Of Royalty Charges (B)</b>	=	<b>46420.0</b>
--	---	----------------

Item No.	Item Of Work.	Qty.	Rate	Unit	Amount
<b>Quality Control Charges Items.</b>					
21	2) Fine Aggregates Carrying out basic tests on Sand for Fineness modulus, Silt and clay content. Spec. No. As directed by Engineer in Charge. SSR I.No.11 P.No.360	6.000	1380.00	/ Test	8280.00
22	4) Basic Test of Concrete Carrying out basic tests on Concrete cubes for compressive strength. Spec. No. As directed by Engineer in Charge. SSR I.No.20 P.No.387	5.000	690.00	/ Test	3450.00
<b>Total Cost Of Quality Control Charges (C)</b>				=	<b>11730.0</b>
<b>Total Cost Of Project (A+B+C)</b>				=	<b>8893700.0</b>

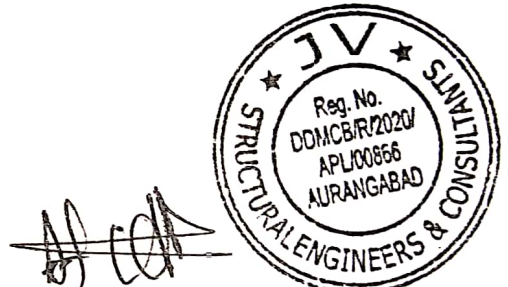

**JV STRUCTURAL  
ENGINEERS AND CONSULTANT  
AURANGABAD**

Name of Work :- Construction of Vegetable dehydration processing plant Shed for Parashara Krishi Farmer Producer Company Ltd. at Tq. Phulambri, Dist. Aurangabad.

Measurement Sheet

Item No.	Item Of Work.	Nos.	Length.	Breadth.	Height.	Quantity.	Unit.
	<b>1. Excavation</b>						
1	Excavation for foundation in earth, soil of all types, sand, gravel and soft murum, including removing the excavated material up to a distance of 50 m. beyond the building area and stacking and spreading as directed, dewatering, preparing the bed for the foundation and necessary back filling, ramming, watering including shoring and strutting etc. complete. (Lift upto 1.5 m.) By Mechanical Means. Bd.A.1 Page 1 Number 259. SSR I.No. 21.02, Sr.No.721, P.No.153						
	<b>Ground Floor</b>						
	Total Footings (36 Nos)						
	Group no.1	36	2.700	1.500	1.500	218.700	
	<b>External Ground beam</b>						
	1-2	1	2.867	0.430	0.300	0.370	
	2-3	1	2.886	0.430	0.300	0.370	
	3-4	1	2.887	0.430	0.300	0.370	
	4-5	1	2.887	0.430	0.300	0.370	
	5-6	1	2.886	0.430	0.300	0.370	
	6-7	1	2.887	0.430	0.300	0.370	
	7-8	1	2.887	0.430	0.300	0.370	
	8-9	1	2.886	0.430	0.300	0.370	
	9-10	1	2.867	0.430	0.300	0.370	
	35-36	1	2.867	0.430	0.300	0.370	
	36-37	1	2.886	0.430	0.300	0.370	
	37-38	1	2.887	0.430	0.300	0.370	
	38-39	1	2.887	0.430	0.300	0.370	
	39-40	1	2.886	0.430	0.300	0.370	
	40-41	1	2.887	0.430	0.300	0.370	
	41-42	1	2.886	0.430	0.300	0.370	
	42-43	1	2.867	0.430	0.300	0.370	
	1-11	1	2.747	0.430	0.300	0.350	
	11-13	1	2.857	0.430	0.300	0.370	
	13-15	1	2.857	0.430	0.300	0.370	
	15-17	1	2.857	0.430	0.300	0.370	
	17-19	1	2.857	0.430	0.300	0.370	
	19-21	1	2.857	0.430	0.300	0.370	
	21-23	1	2.857	0.430	0.300	0.370	
	23-25	1	2.857	0.430	0.300	0.370	
	25-35	1	2.747	0.430	0.300	0.350	
	10-12	1	2.747	0.430	0.300	0.350	
	12-14	1	2.857	0.430	0.300	0.370	
	14-16	1	2.857	0.430	0.300	0.370	
	16-18	1	2.857	0.430	0.300	0.370	
	18-20	1	2.857	0.430	0.300	0.370	
	20-22	1	2.857	0.430	0.300	0.370	
	22-44	1	2.857	0.430	0.300	0.370	

Item No.	Item Of Work.	Nos.	Length.	Breadth.	Height.	Quantity.	Unit.
24-26		1	2.857	0.430	0.300	0.370	
26-44		1	2.747	0.430	0.300	0.350	
<b>Net Qty. For Ground Floor</b>						<b>231.570</b>	<b>Cum</b>
2	Filling in plinth and floors with contractors material/brought from outside and approved by Engineer incharge in layers of 15 cm to 20 cm including watering and compaction etc. complete.. Spec. No. Bd.A.11 Page 1 Number 263. SSR I.No. 21.37, Sr.No. 751, P.No. 157						
<b>Ground Floor</b>							
<b>Total Footings (36 Nos.)</b>							
Group no.1		36	2.70	1.500	1.500	218.700	
<b>Total Excavation Qty. (A) =</b>						<b>218.700</b>	<b>Cum</b>
<b>Deduction</b>							
Qty as per - Excavation It.No.1		1	231.570	1.000	1.000	231.570	
Qty as per - 1:2:4 PCC Below Footing		1	21.870	1.000	1.000	21.870	
Qty as per - M-20 RCC footing		1	48.380	1.000	1.000	48.380	
Qty as per - 20 RCC Col. upto GL		1	7.560	1.000	1.000	7.560	
<b>Total Deduction Qty. (B) =</b>						<b>309.380</b>	<b>Cum</b>
<b>Total Filling Required (A)-(B) =</b>						<b>-90.680</b>	<b>Cum</b>
<b>Under flooring</b>							
Ht = 0.6 - 0.1 - 0.15 = 0.35 m.							
For Vegetable Dehydration		1	29.540	29.540	0.350	305.410	
<b>Net Qty. For Ground Floor</b>						<b>214.730</b>	<b>Cum</b>
3	Providing soling using 80 mm size trap metal in 15 cm. layer including filling voids with Crushed sand/grit, ramming, watering etc. complete.. Spec. No. As directed by Engineer in charge. SSR I.No. 21.40, Sr.No. 754, P.No. 157						
<b>Ground Floor</b>							
<b>Below Flooring</b>							
For Vegetable Dehydration		1	29.540	29.540	0.150	130.890	
<b>Net Qty. For Ground Floor</b>						<b>130.890</b>	<b>Cum</b>
<b>3. Plain Cement Concrete</b>							
4	Providing and laying Cast in situ/Ready Mix cement concrete in M-10 of trap/ granite/ quartzite/ gneiss metal for foundation and bedding including bailing out water, Steel centering, formwork, laying/pumping, compacting, roughening them if special finish is to be provided, finishing if required; and curing complete, with fully automatic micro processor based PLC with SCADA enabled reversible; Drum Type mixer/concrete Batch mix plant (Pan mixer) etc. complete. With fine aggregate (Crushed sand VSI Grade) Spec. No. Bd.E.1 Page 1 No. 287.SSR I.No.24.01, Sr.No.827, P.No.175						

Item No.	Item Of Work.	Nos.	Length.	Breadth.	Height.	Quantity.	Unit.
	<b>Ground Floor</b>						
	<b>Below Flooring</b>						
	For Vegetable Dehydration	1	29.540	29.540	0.100	87.261	
<b>Net Qty. For Ground Floor</b>						<b>87.260</b>	<b>Cum</b>

5	Providing and laying Cast in situ/Ready Mix cement concrete in M15 of trap/ granite/quartzite/gneiss metal for bed blocks, foundation blocks and such other items including bailing out water, Steel centering, formwork, laying/ pumping, compacting, roughening them if special finish is to be provided, finishing uneven and honeycombed surface and curing etc. complete. The Cement Mortar 1:3 plaster is considered for rendering uneven and honeycombed surface only. Newly laid concrete shall be covered by gunny bag, plastic, tarpaulin etc. (Wooden centering will not be allowed.), with fully automatic micro processor based PLC with SCADA enabled reversible Drum Type mixer/ concrete Batch mix plant (Pan mixer) etc. complete. With fine aggregate (Crushed sand VSI Grade) Sepc. No. Bd.E.4 Page Number 289 and B7, Page Number 38. SSR I.No. 24.08, Sr.No. 830, P.176						
	<b>Ground Floor</b>						
	<b>Total Footings (36 Nos.)</b>						
	Group no.1	36	2.700	1.500	0.150	21.870	
<b>Net Qty. For Ground Floor</b>						<b>21.870</b>	<b>Cum</b>

<b>Reinforcement Cement Concrete</b>							
6	Providing and laying in situ /Ready Mix cement concrete M-20 of trap / granite /quartzite/ gneiss metal for R.C.C. work in foundations like raft, strip foundations, grillage and footings of R.C.C. columns and steel stanchions etc. including bailing out water, Steel centering formwork, laying/pumping cover blocks, compaction and curing roughening the surface if special finish is to be provided (Excluding reinforcement and structural steel) etc. complete, with fully automatic micro processor based PLC with SCADA enabled reversible Drum Type mixer/ concrete Batch mix plant (Pan mixer) etc. complete. With fine aggregate (Crushed sand VSI Grade) Spec. No.Bd.F.3 Page 1 No. 298 and B.7, Page No.38. SSR I.No.25.11, Sr.No.836 P.No.178						
	<b>Ground Floor</b>						
	<b>Total Footings (36 Nos.)</b>						
	<b>First Step</b>						
	Group no.1	36	2.400	1.200	0.300	31.100	
	<b>Second Step</b>						
	Group no.1	36	2.000	0.800	0.300	17.280	
<b>Net Qty. For Ground Floor</b>						<b>48.380</b>	<b>Cum</b>

Item No.	Item Of Work.	Nos.	Length.	Breadth.	Height.	Quantity.	Unit.
7	Providing and laying Cast in situ/Ready Mix cement concrete M-20 of trap / granite /quartzite/ gneiss metal for R.C.C. columns as per detailed designs and drawing or as directed including steel centering, formwork, cover blocks, laying/pumping, compaction finishing the formed surfaces with cement mortar 1:3 of sufficient minimum thickness to give a smooth and even surface or roughening if special finish is to be provided and curing etc. complete.(Excluding reinforcement and structural steel).with fully automatic micro processor based PLC with SCADA enabled reversible Drum Type mixer/ concrete Batch mix plant (Pan mixer) etc. complete. With fine aggregate (Crushed sand VSI Grade) Spec. No. :Bd.F.5 Page No. 300 and B.7, Page.No. 38.SSR I.No.25.31, Sr.No.841, P.No.179						
<b>Ground Floor</b>							
<b>Column upto GL</b>							
Group no.1		36	0.400	0.700	0.750	7.560	
<b>Column GL to FFL Ht. 0.60</b>							
Group no.1		36	0.400	0.700	0.600	6.050	
<b>Column FF to GF slab top Ht. 5.60m.</b>							
Group no.1		36	0.400	0.700	5.600	56.450	
<b>Net Qty. For Ground Floor</b>						<b>70.060</b>	<b>Cum</b>

8	Providing and laying Cast in situ/Ready Mix cement concrete M-20 of trap / granite /quartzite/ gneiss metal for R.C.C. beams and lintels as per detailed designs and drawings or as directed including steel centering, formwork, cover blocks, laying/pumping, compaction and roughening the surface if special finish is to be provided and curing etc. complete. (Excluding reinforcement and structural steel). with fully automatic micro processor based PLC with SCADA enabled reversible Drum Type mixer/ concrete Batch mix plant (Pan mixer) etc. complete. With fine aggregate (Crushed sand VSI Grade) Spec. No. :Bd.F.6 Page Number 300 and B.7, Page 1 Number38 Page.No. 38.SSR I.No.25.50, Sr.No.846, P.No.181						
<b>Ground Floor</b>							
<b>External Plinth beam</b>							
<b>B1 - 230 X 450</b>							
1-2		1	2.867	0.230	0.450	0.300	
2-3		1	2.886	0.230	0.450	0.300	
3-4		1	2.887	0.230	0.450	0.300	
4-5		1	2.887	0.230	0.450	0.300	
5-6		1	2.886	0.230	0.450	0.300	
6-7		1	2.887	0.230	0.450	0.300	
7-8		1	2.887	0.230	0.450	0.300	
8-9		1	2.886	0.230	0.450	0.300	
9-10		1	2.867	0.230	0.450	0.300	
35-36		1	2.867	0.230	0.450	0.300	
36-37		1	2.886	0.230	0.450	0.300	
37-38		1	2.887	0.230	0.450	0.300	
38-39		1	2.887	0.230	0.450	0.300	
39-40		1	2.886	0.230	0.450	0.300	

Item No.	Item Of Work.	Nos.	Length.	Breadth.	Height.	Quantity.	Unit.
40-41		1	2.887	0.230	0.450	0.300	
41-42		1	2.886	0.230	0.450	0.300	
42-43		1	2.867	0.230	0.450	0.300	
1-11		1	2.747	0.230	0.450	0.280	
11-13		1	2.857	0.230	0.450	0.300	
13-15		1	2.857	0.230	0.450	0.300	
15-17		1	2.857	0.230	0.450	0.300	
17-19		1	2.857	0.230	0.450	0.300	
19-21		1	2.857	0.230	0.450	0.300	
21-23		1	2.857	0.230	0.450	0.300	
23-25		1	2.857	0.230	0.450	0.300	
25-35		1	2.747	0.230	0.450	0.280	
10-12		1	2.747	0.230	0.450	0.280	
12-14		1	2.857	0.230	0.450	0.300	
14-16		1	2.857	0.230	0.450	0.300	
16-18		1	2.857	0.230	0.450	0.300	
18-20		1	2.857	0.230	0.450	0.300	
20-22		1	2.857	0.230	0.450	0.300	
22-44		1	2.857	0.230	0.450	0.300	
24-26		1	2.857	0.230	0.450	0.300	
26-44		1	2.747	0.230	0.450	0.280	
<b>Lintel Level Beams</b>							
<b>B1 - 230 X 450</b>							
1-2		1	2.867	0.230	0.450	0.300	
2-3		1	2.886	0.230	0.450	0.300	
3-4		1	2.887	0.230	0.450	0.300	
4-5		1	2.887	0.230	0.450	0.300	
5-6		1	2.886	0.230	0.450	0.300	
6-7		1	2.887	0.230	0.450	0.300	
7-8		1	2.887	0.230	0.450	0.300	
8-9		1	2.886	0.230	0.450	0.300	
9-10		1	2.867	0.230	0.450	0.300	
35-36		1	2.867	0.230	0.450	0.300	
36-37		1	2.886	0.230	0.450	0.300	
37-38		1	2.887	0.230	0.450	0.300	
38-39		1	2.887	0.230	0.450	0.300	
39-40		1	2.886	0.230	0.450	0.300	
40-41		1	2.887	0.230	0.450	0.300	
41-42		1	2.886	0.230	0.450	0.300	
42-43		1	2.867	0.230	0.450	0.300	
1-11		1	2.747	0.230	0.450	0.280	
11-13		1	2.857	0.230	0.450	0.300	
13-15		1	2.857	0.230	0.450	0.300	
15-17		1	2.857	0.230	0.450	0.300	
17-19		1	2.857	0.230	0.450	0.300	
19-21		1	2.857	0.230	0.450	0.300	

Item No.	Item Of Work.	Nos.	Length.	Breadth.	Height.	Quantity.	Unit.
21-23		1	2.857	0.230	0.450	0.300	
23-25		1	2.857	0.230	0.450	0.300	
25-35		1	2.747	0.230	0.450	0.280	
10-12		1	2.747	0.230	0.450	0.280	
12-14		1	2.857	0.230	0.450	0.300	
14-16		1	2.857	0.230	0.450	0.300	
16-18		1	2.857	0.230	0.450	0.300	
18-20		1	2.857	0.230	0.450	0.300	
20-22		1	2.857	0.230	0.450	0.300	
22-44		1	2.857	0.230	0.450	0.300	
24-26		1	2.857	0.230	0.450	0.300	
26-44		1	2.747	0.230	0.450	0.280	

**Net Qty. For Ground Floor** **20.840 Cum**

9 Providing and fixing in position TMT - FE - 500 bar reinforcement of various diameters for R.C.C. pile caps, footings, foundations, slabs, beams columns, canopies, staircase, newels, chajjas, lintels, pardis, copings, fins, arches etc. as per detailed designs, drawings and schedules. including cutting, bending, hooking the bars, binding with wires or tack welding and supporting as required complete.. Spec.No. Bd.F.17, Page 1 No. 306. SSR I.No.26.33, Sr.No.871, P.No.188

Ground Floor							
Qty. As Per Item. M20 Footing			48.380	15.00	Kg/Cum	725.70	
Qty. As Per Item. M20 Column			70.060	140.00	Kg/Cum	9808.40	
Qty. As Per Item. M20 Beams			20.840	140.00	Kg/Cum	2917.60	
<b>Total Qty. =</b>						<b>13451.70</b>	<b>Kg.</b>

**Net Qty. For Ground Floor** **13.450 /M.T.**

10 Providing structural steel work in trusses, other similar trussed purlins and members with all bracing, gusset plates etc. as per detailed designs and drawings or as directed including cutting, fabricating, hoisting, erecting fixing in position, Making riveted/ bolted/ welded connection and one coat of anticorrosive paint and over it 2 coats of oil painting approved quality and shade etc. complete. Spec.No. Bd.C.8 Page Number 278 SSR I.No.23.04, Sr.No.819, P.No.173

Ground Floor							
For Vegetable Dehydration		1	30.000	30.00	16.000	14400.000	
<b>Total Qty. =</b>						<b>14400.00</b>	<b>Kg.</b>

**Net Qty. For Ground Floor** **14.400 /M.T.**

11 Providing and fabricating structural steel work in rolled sections like joists, channels, angles, tees etc. as per detailed design and drawings or as directed including cutting, fabricating, hoisting, erecting, fixing in position making riveted / bolted /welded connections without connecting plates, braces etc. and including one coat of anticorrosive paint and over it two coats of oil painting of approved quality and shade etc. complete.. Spec. No. Bd.C.2 Page 1 Number 275 SSR I.No.23.01, Sr.No.816, P.No.173

Ite m No.	Item Of Work.	Nos.	Length.	Breadth.	Height.	Quantity.	Unit.
<b>Ground Floor</b>							
	Steel Column 2ISMC 200 @ 44.20Kg/m.	36	5.900	1.00	44.200	9388.080	
<b>Beam Below Truss ISMC 200 @ 22.10Kg/m.</b>							
	1-2	1	2.867	1.000	22.100	63.360	
	2-3	1	2.886	1.000	22.100	63.780	
	3-4	1	2.887	1.000	22.100	63.800	
	4-5	1	2.887	1.000	22.100	63.800	
	5-6	1	2.886	1.000	22.100	63.780	
	6-7	1	2.887	1.000	22.100	63.800	
	7-8	1	2.887	1.000	22.100	63.800	
	8-9	1	2.886	1.000	22.100	63.780	
	9-10	1	2.867	1.000	22.100	63.360	
	35-36	1	2.867	1.000	22.100	63.360	
	36-37	1	2.886	1.000	22.100	63.780	
	37-38	1	2.887	1.000	22.100	63.800	
	38-39	1	2.887	1.000	22.100	63.800	
	39-40	1	2.886	1.000	22.100	63.780	
	40-41	1	2.887	1.000	22.100	63.800	
	41-42	1	2.886	1.000	22.100	63.780	
	42-43	1	2.867	1.000	22.100	63.360	
	1-11	1	2.747	1.000	22.100	60.710	
	11-13	1	2.857	1.000	22.100	63.140	
	13-15	1	2.857	1.000	22.100	63.140	
	15-17	1	2.857	1.000	22.100	63.140	
	17-19	1	2.857	1.000	22.100	63.140	
	19-21	1	2.857	1.000	22.100	63.140	
	21-23	1	2.857	1.000	22.100	63.140	
	23-25	1	2.857	1.000	22.100	63.140	
	25-35	1	2.747	1.000	22.100	60.710	
	10-12	1	2.747	1.000	22.100	60.710	
	12-14	1	2.857	1.000	22.100	63.140	
	14-16	1	2.857	1.000	22.100	63.140	
	16-18	1	2.857	1.000	22.100	63.140	
	18-20	1	2.857	1.000	22.100	63.140	
	20-22	1	2.857	1.000	22.100	63.140	
	22-44	1	2.857	1.000	22.100	63.140	
	24-26	1	2.857	1.000	22.100	63.140	
	26-44	1	2.747	1.000	22.100	60.710	
						<b>Total Qty. =</b>	<b>11597.60 Kg.</b>
<b>Net Qty. For Ground Floor</b>							<b>11.600 /M.T.</b>

Ite m No.	Item Of Work.	Nos.	Length.	Breadth.	Height.	Quantity.	Unit.
<b>Brick Work</b>							
12	Providing second class Burnt Brick masonry with conventional/ I.S. type bricks in cement mortar 1:6 in foundations and plinth of inner walls/ in plinth external walls including bailing out water manually, striking joints on unexposed faces, raking out joints on exposed faces and watering etc. Complete. Spec. No. As directed by engineer in charge and BDG- 2 and 5. SSR I.No.27.01, Sr.No.889 P.No.197						
<b>Ground Floor</b>							
External plinth beam (Plinth Ht = 0.75 - 0.15 - 0.15 = 0.450 m.)							
	1-2	1	2.867	0.230	0.300	0.200	
	2-3	1	2.886	0.230	0.300	0.200	
	3-4	1	2.887	0.230	0.300	0.200	
	4-5	1	2.887	0.230	0.300	0.200	
	5-6	1	2.886	0.230	0.300	0.200	
	6-7	1	2.887	0.230	0.300	0.200	
	7-8	1	2.887	0.230	0.300	0.200	
	8-9	1	2.886	0.230	0.300	0.200	
	9-10	1	2.867	0.230	0.300	0.200	
	35-36	1	2.867	0.230	0.300	0.200	
	36-37	1	2.886	0.230	0.300	0.200	
	37-38	1	2.887	0.230	0.300	0.200	
	38-39	1	2.887	0.230	0.300	0.200	
	39-40	1	2.886	0.230	0.300	0.200	
	40-41	1	2.887	0.230	0.300	0.200	
	41-42	1	2.886	0.230	0.300	0.200	
	42-43	1	2.867	0.230	0.300	0.200	
	1-11	1	2.747	0.230	0.300	0.190	
	11-13	1	2.857	0.230	0.300	0.200	
	13-15	1	2.857	0.230	0.300	0.200	
	15-17	1	2.857	0.230	0.300	0.200	
	17-19	1	2.857	0.230	0.300	0.200	
	19-21	1	2.857	0.230	0.300	0.200	
	21-23	1	2.857	0.230	0.300	0.200	
	23-25	1	2.857	0.230	0.300	0.200	
	25-35	1	2.747	0.230	0.300	0.190	
	10-12	1	2.747	0.230	0.300	0.190	
	12-14	1	2.857	0.230	0.300	0.200	
	14-16	1	2.857	0.230	0.300	0.200	
	16-18	1	2.857	0.230	0.300	0.200	
	18-20	1	2.857	0.230	0.300	0.200	
	20-22	1	2.857	0.230	0.300	0.200	
	22-44	1	2.857	0.230	0.300	0.200	
	24-26	1	2.857	0.230	0.300	0.200	
	26-44	1	2.747	0.230	0.300	0.190	
<b>Net Qty. For Ground Floor</b>						<b>6.960</b>	<b>Cum</b>

Item No.	Item Of Work.	Nos.	Length.	Breadth.	Height.	Quantity.	Unit.
13	Providing second class Burnt Brick masonry with conventional/ I.S. type bricks in cement mortar 1:6 in foundations and plinth of inner walls/ in plinth external walls including bailing out water manually, striking joints on unexposed faces, raking out joints on exposed faces and watering etc. Complete. Spec. No. As director by engineer in charge and BDG- 2 and 5. SSR I.No.27.01, Sr.No.889 P.No.197						
<b>Ground Floor</b>							
Ht = 5.6 - 0.45 = 3 m.							
1-2		1	2.867	0.230	3.000	1.980	
2-3		1	2.886	0.230	3.000	1.990	
3-4		1	2.887	0.230	3.000	1.990	
4-5		1	2.887	0.230	3.000	1.990	
5-6		1	2.886	0.230	3.000	1.990	
6-7		1	2.887	0.230	3.000	1.990	
7-8		1	2.887	0.230	3.000	1.990	
8-9		1	2.886	0.230	3.000	1.990	
9-10		1	2.867	0.230	3.000	1.980	
35-36		1	2.867	0.230	3.000	1.980	
36-37		1	2.886	0.230	3.000	1.990	
37-38		1	2.887	0.230	3.000	1.990	
38-39		1	2.887	0.230	3.000	1.990	
39-40		1	2.886	0.230	3.000	1.990	
40-41		1	2.887	0.230	3.000	1.990	
41-42		1	2.886	0.230	3.000	1.990	
42-43		1	2.867	0.230	3.000	1.980	
1-11		1	2.747	0.230	3.000	1.900	
11-13		1	2.857	0.230	3.000	1.970	
13-15		1	2.857	0.230	3.000	1.970	
15-17		1	2.857	0.230	3.000	1.970	
17-19		1	2.857	0.230	3.000	1.970	
19-21		1	2.857	0.230	3.000	1.970	
21-23		1	2.857	0.230	3.000	1.970	
23-25		1	2.857	0.230	3.000	1.970	
25-35		1	2.747	0.230	3.000	1.900	
10-12		1	2.747	0.230	3.000	1.900	
12-14		1	2.857	0.230	3.000	1.970	
14-16		1	2.857	0.230	3.000	1.970	
16-18		1	2.857	0.230	3.000	1.970	
18-20		1	2.857	0.230	3.000	1.970	
20-22		1	2.857	0.230	3.000	1.970	
22-44		1	2.857	0.230	3.000	1.970	
24-26		1	2.857	0.230	3.000	1.970	
26-44		1	2.747	0.230	3.000	1.900	
<b>Deduction</b>							
	Rolling Shutter	-2	2.400	0.230	2.400	-2.650	
<b>Net Qty. For Ground Floor</b>						<b>66.320</b>	<b>Cum</b>

Item No.	Item Of Work.	Nos.	Length.	Breadth.	Height.	Quantity.	Unit.
----------	---------------	------	---------	----------	---------	-----------	-------

### Plastering & Pointing

- 14 Providing sand faced plaster externally in cement mortar using approved screened sand, in all positions including base coat of 15 mm thick in cement mortar 1:4 using waterproofing compound at 1 Kilogram per cement bag curing the same for not less than 2 days and keeping the surface of the base coat rough to receive the sand faced treatment 6 to 8 mm thick in cement mortar 1:4 finishing the surface by taking out grains and curing for fourteen days scaffolding etc. complete. Spec. No. : Bd.L.7 Page 1 No. 369. SSR I.No.32.11, Sr.No.963, P.No.209

#### Ground Floor

External walls (Ht = 0.75+4.00 = 4.75 m.)

Horizontal Side	2	30.000	-	0.600	36.000	
Vertical Side	2	30.000	-	0.600	36.000	
For Column Offset	72	0.400	-	5.600	161.280	
For Column Offset	72	0.700	-	5.600	282.240	

#### Net Qty. For Ground Floor

515.520 Sqm

### Oil Painting

- 15 Providing and applying three coats of water proof cement paint of approved manufacture and of approved colour to new plastered surfaces including scaffolding if necessary, cleaning and preparing the surface, watering for two days etc. complete. Spec. No. : As directed by Engineer in charge. SSR I.No.35.15, Sr.No.1085, P.no.224

#### Ground Floor

Qty. (External Side Plaster)	1	515.52	1.000	-	515.520	
------------------------------	---	--------	-------	---	---------	--

#### Net Qty. For Ground Floor

515.520 Sqm

- 16 Providing and applying two coats of synthetic enamel paint of approved colour to new /old structural steel work and wood work in buildings, including scaffolding if necessary, cleaning and preparing the surface (excluding primer coat) etc. complete. Spec. No. Bd.0.5 Page 1 No. 405..SSR I.No.35.07, Sr.No.1077 P.No.227

#### Ground Floor

Rolling Shutter	2	2.40	2.400	-	11.520	
-----------------	---	------	-------	---	--------	--

#### Net Qty. For Ground Floor

11.520 Sqm

- 17 Providing and fixing rolling shutter fabricated from steel laths of minimum thickness 0.9 mm with lock plate of 3.15 mm thickness reinforced with 35 x 35 x 5 mm angle section fitted with sliding bolts and handles for both sides, deep M.S. channel section of depth and thickness not less than 65 mm and 3.15 mm respectively with hold fast arrangements, M.S. Bracket plate 300 x 300 x 3.15 mm minimum size and shape with square bar, suspension shaft of minimum 32 mm diameter, hood cover of M.S. sheet not less than 0.9 mm thickness and of any size at top and safety devices including mechanical gear operation arrangement consisting of worm gear wheels and worms of high grade cast iron or mild steel and one coat of red lead primer etc. complete. (I.S. 62481979) (With mechanical gear) Spec.No.: BD.V 5 page 551 and as directed by Engineer in charge. SSR I.No.39.25, Sr.No.1218, P.No.249

#### Ground Floor

Rolling Shutter	2	2.40	2.400	-	11.520	
-----------------	---	------	-------	---	--------	--

#### Net Qty. For Ground Floor

11.520 Sqm

Item No.	Item Of Work.	Nos.	Length.	Breadth.	Height.	Quantity.	Unit.
----------	---------------	------	---------	----------	---------	-----------	-------

18 Providing and fixing corrugated galvanised iron sheets of 0.63mm thick (24 B.W.G.) for roofing without wind tiles including fastening with galvanised iron screws and bolts, lead and bitumen washers as per drawing etc. complete. (Weight of 5.5 Kilogram/sq.m.). Spec.No.: Bd.R.5, Page One Number 453. SSR I.No.38.04, Sr.No.1144, P.No.233

**Ground Floor**

For Shed

1	30.000	30.000	-	900.000
---	--------	--------	---	---------

**Net Qty. For Ground Floor**

**900.000 Sqm**

19 Providing and fixing colour coated Zinalume ( R ) AZ150 ( min 150 gms/sq.mt. total on each side profiled sheets for roofing. The feed material is manufactured out of nominal 0.45 mm Base Metal Thickness BMT ) (0.5 mm TCT ), Hi-strength steel with min.550 MPa yield strength, metallic hot dip coated with Aluminium-Zinc alloy (55% aluminium 43.4% zinc 1.6% silicon) with COLORBOND ( R ) steel quality super durable polyester paint coat ( with inorganic pigment). The paint shall have a total coating thickness of nominal 35 um, comprising of nominal 25 um exterior coat on top surface and nominal 10 um reverse coat on back surface. Profile sheet shall have nom. 950-1050 mm effective cover width and nominal 25-30 mm deep ribs with subtle square fluting in the five pan at nominal 180-250 mm center- to-center. The end rib shall be designed for anti-capillary groove. and return leg. The feed material should have co-manufacturers product details marked at a regular interval. Including fasteners with min. fastened with min. 25 um Zinc-Tin alloy coated, Hex head, self-drilling screw etc. complete. (weight of profile 4.52 Kilogram/Square Metre) Spec. No. As directed by Engineer in Charge SSR I.No.38.34, Sr.No.1174 P.No.236

**Ground Floor**

**Net Qty. For Ground Floor**

**0.000 Sqm**

20 Royalty Charges-as per statement attached

For Sand

1	0.00	1.000	-	0.000
---	------	-------	---	-------

For Murum

1	214.73	1.000	-	214.730
---	--------	-------	---	---------

**Quality Control Charges Items.**

**2) Fine Aggregates**

21 Carrying out basic tests on Sand for Fineness modulus, Silt and clay content. Spec.No. As directed by Engineer in Charge. SSR I.No.11 P.No.360

6	-	-	-	6.000
---	---	---	---	-------

**Net Qty. For Ground Floor**

**6.000 /Test**

Item No.	Item Of Work.	Nos.	Length.	Breadth.	Height.	Quantity.	Unit.
4)	Basic Test of Concrete						
22	Carrying out basic tests on Concrete cubes for compressive strength.Spec.No.As directed by Engineer in Charge.SSR I.No.20 P.No.387						
	Net Qty. For Ground Floor	5	-	-	-	5.000	
						5.000	/Test

*[Handwritten Signature]*

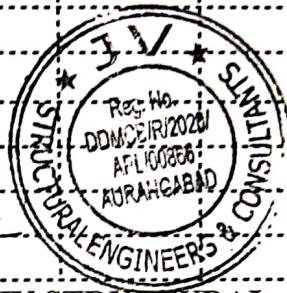

**JV STRUCTURAL  
ENGINEERS AND CONSULTANT  
AURANGABAD**

Name of Work :- Construction of Vegetable dehydration processing plant Shed for Parashara Krishi Farmer Producer Company Ltd. at Tq. Phulambri, Dist. Aurangabad.

Rate Analysis

Sl. No.	Item Of Work.	Unit.
<b>Excavation</b>		
1	Excavation for foundation in earth, soil of all types, sand, gravel and soft murum, including removing the excavated material up to a distance of 50 m. beyond the building area and stacking and spreading as directed, dewatering, preparing the bed for the foundation and necessary back filling, ramming, watering including shoring and strutting etc. complete. (Lift upto 1.5 m.) By Mechanical Means. Bd.A.1 Page 1 Number 259. SSR I.No. 21.02, Sr.No.721, P.No.153	
	Basic Rate As Per SSR 2022-23	Rs : 207.00
	<b>Net Amount For Ground Floor</b>	<b>207.000 /Cum</b>
<b>Filling in plinth and floors with contractors material/brought from outside and approved by Engineer incharge in layers of 15 cm to 20 cm including watering and compaction etc. complete.. Spec. No. Bd.A.11 Page 1 Number 263. SSR I.No. 21.37, Sr.No. 751, P.No. 157</b>		
2		
	Basic Rate As Per SSR 2022-23	Rs : 599.00
	Add Lead Charges For Hard Murum 1 1.00 219.98	Rs : 219.98
	<b>Net Amount For Ground Floor</b>	<b>818.980 /Cum</b>
<b>Providing soling using 80 mm size trap metal in 15 cm. layer including filling voids with Crushed sand/grit, ramming, watering etc. complete.. Spec. No. As directed by Engineer in charge. SSR I.No. 21.40, Sr.No. 754, P.No. 157</b>		
3		
	Basic Rate As Per SSR 2022-23	Rs : 1454.00
	Add Lead Charges For Metal 1 1.00 540.53	Rs : 540.53
	Add Lead Charges For Sand 1 0.15 358.73	Rs : 53.81
	<b>Net Amount For Ground Floor</b>	<b>2048.340 /Cum</b>
<b>Plain Cement Concrete</b>		
<b>4 Providing and laying Cast in situ/Ready Mix cement concrete in M-10 of trap/ granite/ quartzite/ gneiss metal for foundation and bedding including bailing out water, Steel centering, formwork, laying/pumping, compacting, roughening them if special finish is to be provided, finishing if required and curing complete, with fully automatic micro processor based PLC with SCADA enabled reversible Drum Type mixer/concrete Batch mix plant (Pan mixer) etc. complete. With fine aggregate (Crushed sand VSI Grade) Spec. No. Bd.E.1 Page 1 No. 287.SSR I.No.24.01, Sr.No.827, P.No.175</b>		
	Basic Rate As Per SSR 2022-23	Rs : 5830.00
	Add Lead Charges For 40mm Metal 1 0.70 423.41	Rs : 296.39
	Add Lead Charges For 20mm Metal 1 0.24 441.82	Rs : 106.04
	Add Lead Charges For Sand 1 0.47 358.73	Rs : 168.60
	Add Lead Charges For Cement 1 0.22 135.46	Rs : 29.80
	<b>Net Amount For Ground Floor</b>	<b>6430.830 /Cum</b>

- 5 Providing and laying Cast in situ/Ready Mix cement concrete in M15 of trap/ granite/quartzite/gneiss metal for bed blocks, foundation blocks and such other items including bailing out water, Steel centering, formwork, laying/ pumping, compacting, roughening them if special finish is to be provided, finishing uneven and honeycombed surface and curing etc. complete. The Cement Mortar 1:3 plaster is considered for rendering uneven and honeycombed surface only. Newly laid concrete shall be covered by gunny bag, plastic, tarpaulin etc. (Wooden centering will not be allowed.), with fully automatic micro processor based PLC with SCADA enabled reversible Drum Type mixer/ concrete Batch mix plant (Pan mixer) etc. complete. With fine aggregate (Crushed sand VSI Grade) Sepec. No. Bd.E.4 Page Number 289 and B7, Page Number38. SSR I.No. 24.08, Sr.No. 830, P.176

Basic Rate As Per SSR 2022-23				Rs :	6359.00
Add Lead Charges For 40mm Metal	1	0.56	423.41	Rs :	237.11
Add Lead Charges For 20mm Metal	1	0.22	441.82	Rs :	97.20
Add Lead Charges For 10 / 12mm Metal	1	0.11	441.82	Rs :	48.60
Add Lead Charges For Sand	1	0.44	358.73	Rs :	157.84
Add Lead Charges For Cement	1	0.30	135.46	Rs :	40.64

**Net Amount For Ground Floor** **6940.390 /Cum**

### Reinforcement Cement Concrete

- 6 Providing and laying in situ /Ready Mix cement concrete M-20 of trap / granite /quartzite/ gneiss metal for R.C.C. work in foundations like raft, strip foundations, grillage and footings of R.C.C. columns and steel stanchions etc. including bailing out water, Steel centering formwork, laying/pumping cover blocks, compaction and curing roughening the surface if special finish is to be provided (Excluding reinforcement and structural steel) etc. complete, with fully automatic micro processor based PLC with SCADA enabled reversible Drum Type mixer/ concrete Batch mix plant (Pan mixer) etc. complete. With fine aggregate (Crushed sand VSI Grade) Spec. No.Bd.F.3 Page 1 No. 298 and B.7, Page No.38. SSR I.No.25.11, Sr.No.836 P.No.178

Basic Rate As Per SSR 2022-23				Rs :	7104.00
Add Lead Charges For 20mm Metal	1	0.570	441.82	Rs :	251.84
Add Lead Charges For 10 / 12mm Metal	1	0.280	441.82	Rs :	123.71
Add Lead Charges For Sand	1	0.425	358.73	Rs :	152.46
Add Lead Charges For Cement	1	0.350	135.46	Rs :	47.41

**Net Amount For Ground Floor** **7679.420 /Cum**

- 7 Providing and laying Cast in situ/Ready Mix cement concrete M-20 of trap / granite /quartzite/ gneiss metal for R.C.C. columns as per detailed designs and drawing or as directed including steel centering, formwork, cover blocks, laying/pumping, compaction finishing the formed surfaces with cement mortar 1:3 of sufficient minimum thickness to give a smooth and even surface or roughening if special finish is to be provided and curing etc. complete.(Excluding reinforcement and structural steel).with fully automatic micro processor based PLC with SCADA enabled reversible Drum Type mixer/ concrete Batch mix plant (Pan mixer) etc. complete. With fine aggregate (Crushed sand VSI Grade) Spec. No. : Bd.F.5 Page No. 300 and B.7, Page.No. 38.SSR I.No.25.31, Sr.No.841, P.No.179

Basic Rate As Per SSR 2022-23				Rs :	13783.00
Add Lead Charges For 20mm Metal	1	0.570	441.82	Rs :	251.84
Add Lead Charges For 10 / 12mm Metal	1	0.280	441.82	Rs :	123.71
Add Lead Charges For Sand	1	0.425	358.73	Rs :	152.46
Add Lead Charges For Cement	1	0.350	135.46	Rs :	47.41

**Net Amount For Ground Floor** **14358.420 /Cum**

- 8 Providing and laying Cast in situ/Ready Mix cement concrete M-20 of trap / granite /quartzite/ gneiss metal for R.C.C. beams and lintels as per detailed designs and drawings or as directed including steel centering, formwork, cover blocks, laying/pumping, compaction and roughening the surface if special finish is to be provided and curing etc. complete. (Excluding reinforcement and structural steel). with fully automatic micro processor based PLC with SCADA enabled reversible Drum Type mixer/ concrete Batch mix plant (Pan mixer) etc. complete. With fine aggregate (Crushed sand VSI Grade) Spec. No. :Bd.F.6 Page Number 300 and B.7, Page 1 Number 38 Page.No. 38.SSR I.No.25.50, Sr.No.846, P.No.181

Basic Rate As Per SSR 2022-23				Rs :	12269.00
Add Lead Charges For 20mm Metal	1	0.570	441.82	Rs :	251.84
Add Lead Charges For 10 / 12mm Metal	1	0.280	441.82	Rs :	123.71
Add Lead Charges For Sand	1	0.425	358.73	Rs :	152.46
Add Lead Charges For Cement	1	0.350	135.46	Rs :	47.41

**Net Amount For Ground Floor** **12844.420 /Cum**

- 9 Providing and fixing in position TMT - FE - 500 bar reinforcement of various diameters for R.C.C. pile caps, footings, foundations, slabs, beams columns, canopies, staircase, newels, chajjas, lintels, copings, fins, arches etc. as per detailed designs, drawings and schedules. including cutting, bending, hooking the bars, binding with wires or tack welding and supporting as required complete.. Spec.No. Bd.F.17, Page 1 No. 306. SSR I.No.26.33, Sr.No.871, P.No.188

Basic Rate As Per SSR 2022-23				Rs :	89703.00
Add Lead Charges For Steel	1	1.00	135.46	Rs :	135.46

**Net Amount For Ground Floor** **89838.460 /M.T.**

- 10 Providing structural steel work in trusses, other similar trussed purlins and members with all bracing, gusset plates etc. as per detailed designs and drawings or as directed including cutting, fabricating, hoisting, erecting fixing in position, Making riveted/ bolted/ welded connection and one coat of anticorrosive paint and over it 2 coats of oil painting approved quality and shade etc. complete.Spec.No. Bd.C.8 Page Number 278 SSR I.No.23.04, Sr.No.819, P.No.173

Basic Rate As Per SSR 2022-23				Rs :	119459.00
Add Lead Charges For Steel	1	1.00	135.46	Rs :	135.46

**Net Amount For Ground Floor** **119594.46 /M.T.**

- 11 Providing and fabricating structural steel work in rolled sections like joists, channels, angles, tees etc. as per detailed design and drawings or as directed including cutting, fabricating, hoisting, erecting, fixing in position making riveted / bolted /welded connections without connecting plates, braces etc. and including one coat of anticorrosive paint and over it two coats of oil painting of approved quality and shade etc. complete.. Spec. No. Bd.C.2 Page 1 Number 275 SSR I.No.23.01, Sr.No.816, P.No.173

Basic Rate As Per SSR 2022-23				Rs :	101844.00
Add Lead Charges For Steel	1	1.00	135.46	Rs :	135.46

**Net Amount For Ground Floor** **Rs : 101979.46 /M.T.**

**Brick Work**

- 12 Providing second class Burnt Brick masonry with conventional/ I.S. type bricks in cement mortar 1:6 in foundations and plinth of inner walls/ in plinth external walls including bailing out water manually , striking joints on unexposed faces, raking out joints on exposed faces and watering etc. Complete. Spec. No. As directed by engineer in charge and BDG- 2 and 5. SSR I.No.27.01, Sr.No.889 P.No.197

Basic Rate As Per SSR 2022-23				Rs :	7755.00
Add Lead Charges For Brick	1	0.475	1205.060	Rs :	572.40

Sl. No. Item Of Work.

Sl. No.	Item Of Work.	Unit.
	Add Lead Charges For Sand	1 0.320 358.730 Rs : 114.79
	Add Lead Charges For Cement	1 0.079 135.460 Rs : 10.70
	<b>Net Amount For Ground Floor</b>	<b>8452.900 /Cum</b>

- 13 Providing second class Burnt Brick masonry with conventional/ I.S. type bricks in cement mortar 1:6 in superstructure including striking joints, raking out joints, watering and scaffolding etc. Complete Spec. No. Bd.G.5 Page One Number 315. SSR I.No.27.05, Sr.No.892 P.No.197

Basic Rate As Per SSR 2022-23

Add Lead Charges For Brick	1	0.475	1205.060	Rs :	7994.00
Add Lead Charges For Sand	1	0.320	358.730	Rs :	572.40
Add Lead Charges For Cement	1	0.079	135.460	Rs :	114.79
<b>Net Amount For Ground Floor</b>					<b>10.70</b>

**8691.900 /Cum**

### Plastering & Pointing

- 14 Providing sand faced plaster externally in cement mortar using approved screened sand, in all positions including base coat of 15 mm thick in cement mortar 1:4 using waterproofing compound at 1Kilogramper cement bag curing the same for not less than 2 days and keeping the surface of the base coat rough to receive the sand faced treatment 6 to 8 mm thick in cement mortar 1:4 finishing the surface by taking out grains and curing for fourteen days scaffolding etc.complete. Spec. No. : Bd.L.7 Page 1 No. 369. SSR I.No.32.11, Sr.No.963, P.No.209

Basic Rate As Per SSR 2022-23

Add Lead Charges For Sand	1	0.033	358.730	Rs :	639.00
Add Lead Charges For Cement	1	0.0125	135.460	Rs :	11.84
<b>Net Amount For Ground Floor</b>					<b>1.69</b>

**652.530 /Sqm**

### Oil Painting

- 15 Providing and applying three coats of water proof cement paint of approved manufacture and of approved colour to new plastered surfaces including scaffolding if necessary, cleaning and preparing the surface, watering for two days etc. complete. Spec. No. : As directed by Engineer in charge. SSR I.No.35.15, Sr.No.1085, P.no.224

Basic Rate As Per SSR 2022-23

Rs : 104.00

**Net Amount For Ground Floor**

**104.000 /Sqm**

- 16 Providing and applying two coats of synthetic enamel paint of approved colour to new /old structural steel work and wood work in buildings, including scaffolding if necessary, cleaning and preparing the surface (excluding primer coat) etc. complete. Spec. No. Bd.0.5 Page 1 No. 405..SSR I.No.35.07, Sr.No.1077 P.No.227

Basic Rate As Per SSR 2022-23

Rs : 96.00

**Net Amount For Ground Floor**

**96.000 /Sqm**

- 17 Providing and fixing rolling shutter fabricated from steel laths of minimum thickness 0.9 mm with lock plate of 3.15 mm thickness reinforced with 35 x 35 x 5 mm angle section fitted with sliding bolts and handles for both sides, deep M.S. channel section of depth and thickness not less than 65 mm and 3.15 mm respectively with hold fast arrangements, M.S. Bracket plate 300 x 300 x 3.15 mm minimum size and shape with square bar, suspension shaft of minimum 32 mm diameter, hood cover of M.S. sheet not less than 0.9 mm thickness and of any size at top and safety devices including mechanical gear operation arrangement consisting of worm gear wheels and worms of high grade cast iron or mild steel and one coat of red lead primer etc. complete. (I.S. 62481979) (With mechanical gear) Spec.No.: BD.V 5 page 551 and as directed by Engineer in charge. SSR I.No.39.25, Sr.No.1218, P.No.249

It. No.	Item Of Work.	Unit.
	Basic Rate As Per SSR 2022-23	Rs : 5308.00
	Add Lead Charges For Steel	Rs : 135.46
	<b>Net Amount For Ground Floor</b>	<b>5443.460 /Sqm</b>

18 Providing and fixing corrugated galvanised iron sheets of 0.63mm thick (24 B.W.G.) for roofing without wind tiles including fastening with galvanised iron screws and bolts, lead and bitumen washers as per drawing etc. complete.(Weight of 5.5 Kilogram/sq.m.). Spec.No.: Bd.R.5, Page One Number 453. SSR I.No.38.04, Sr.No.1144, P.No.233

	Basic Rate As Per SSR 2022-23	Rs : 870.00
	<b>Net Amount For Ground Floor</b>	<b>870.000 /Sqm</b>

19 Providing and fixing colour coated Zinalume ( R ) AZ150 ( min 150 gms/sq.mt. total on each side profiled sheets for roofing. The feed material is manufactured out of nominal 0.45 mm Base Metal Thickness BMT ) (0.5 mm TCT ), Hi-strength steel with min.550 MPa yield strength, metallic hot dip coated with Aluminium-Zinc alloy (55% aluminium 43.4% zinc 1.6% silicon) with COLORBOND ( R ) steel quality super durable polyester paint coat ( with inorganic pigment). The paint shall have a total coating thickness of nominal 35 um, comprising of nominal 25 um exterior coat on top surface and nominal 10 um reverse coat on back surface. Profile sheet shall have nom. 950-1050 mm effective cover width and nomina25-30 mm deep ribs with subtle square fluting in the five pan at nominal 180-250 mm center- to-center. The end rib shall be designed for anti-capillary groove. and return leg. The feed material should have coimanufacturers product details marked a regular interval. Including fasteners with min. fastened with min. 25 um Zinc-Tin alloy coated, Hex head, self-drilling screw etc. complete. (weight of profile 4.52 Kilogram/Square Metre)Spec. No. As directed by Engineer in Charge SSR I.No.38.34, Sr.No.1174 P.No.236

	Basic Rate As Per SSR 2021-22	Rs : 1173.00
	<b>Net Amount For Ground Floor</b>	<b>1173.000 /Sqm</b>

*Handwritten signature*

**JV STRUCTURAL  
ENGINEERS AND CONSULTANT  
AURANGABAD**



Name of Work :- Construction of Vegetable dehydration processing plant Shed for Parashara Krishi Farmer Producer Company Ltd. at Tq. Phulambri, Dist. Aurangabad.

Testing Charges for Construction Materials

Carring out various following tests for

Sr.No.	Materials	Test	Qty.	Unit	Frequency Required	No.of Tests	Rate/Test	Total Amount
2	Sand	Fineness mod., Moisture content, Bulkage and silt factor	150.93	Cum	per source	1	1380.00	1380.00
3	Concrete cubes	Comp.strengthof cubes,	248.41	Cum	1 - 5 Cum 1 Test 6 - 15 Cum 2 Test 16 - 30 Cum 3 Test 31 - 50 Cum 4 Test 50 & Above 4 Plus	8	690.00	5520.00
<b>Total Rs.</b>								<b>6900.00</b>

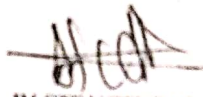
  
 JV STRUCTURAL  
 ENGINEERS AND CONSULTANT  
 AURANGABAD

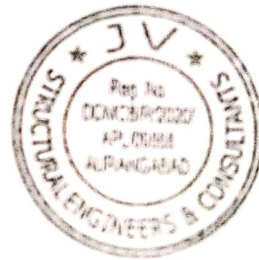

**Name of Work :- Construction of Vegetable dehydration processing plant  
Shed for Parashara Krishi Farmer Producer Company Ltd. at Tq.  
Phulambri, Dist. Aurangabad.**

**Royalty Statement For Court Building**

Item	ITEM OF WORK	UNIT	TOTAL QTY.	SAND		SM / HM	
				Cons. Rate	Qty.		
2	Filling in plinth and floors with contractors material/brought from outside and approved by Engineer incharge in layers of 15 cm to	Cum	214.73	-	-	1.000	214.730
3	Providing soling using 80 mm size trap metal in 15 cm. layer including filling voids with Crushed sand / grit, ramming, watering	Cum	130.890	0.000	0.000	-	-
4	Providing and laying in situ / ready mix cement concrete of M10 proportion with trap/ granite/ quartzite/ gneiss metal in foundation including SSR I.No.11.02 P.No.	Cum	87.260	0.000	0.000	-	-
5	Providing and laying Cast in situ/Ready Mix cement concrete in M15 of trap/ granite/quartzite/gneiss metal for bed blocks, foundation blocks and such other items including bailing out water, Steel centering, formwork, laying/ pumping, compacting, roughening them if special finish is to be provided, finishing uneven and honeycombed surface and curing etc. complete. The Cement Mortar 1:3 plaster is considered for rendering uneven and honeycombed surface only. Newly laid concrete shall be covered by gunny bag, plastic, tarpaulin etc. (Wooden centering will not be allowed.), with fully automatic micro processor based PLC with SCADA enabled reversible Drum Type mixer/ concrete Batch mix plant (Pan mixer) etc. complete. With fine aggregate (Crushed sand VSI Grade) Sepc. No. Bd.E.4 Page Number 289 and B7, Page Number38. SSR I.No. 24.08, Sr.No. 830, P.176	Cum	21.870	0.000	0.000	-	-
6	Providing and laying in situ/ Ready Mix cement concrete M-20 of trap / granite / quartzite/ gneiss metal for R.C.C. work in foundations like raft , strip SSR I.No.25.11 P.No.180	Cum	48.380	0.000	0.000	-	-
7	Providing and laying Cast in situ/ Ready Mix cement concrete M-20 of trap / granite/ quartzite/ gneiss metal for R.C.C. columns as per detailed designs and SSR I.No.25.31 P.No.183						
Ground Floor		Cum	70.060	0.000	0.000	-	-



Name of Work :- Construction of Vegetable dehydration processing plant Shed for Parashara Krishi Farmer Producer Company Ltd. at Tq. Phulambri, Dist. Aurangabad.

**LEAD CHART**

Sr.N	Material	Total Lead in km	Pay Load Factor	Rate per Trip	Net Lead Charges/Trip	Remarks
1	Stone/Rubble	17.00	4.70	2540.48	540.53	Sawangi Quarry
2	60 mm & 40 mm metal	17.00	6.00	2540.48	423.41	Sawangi Quarry
3	Metal Below 40 mm	17.00	5.75	2540.48	441.82	Sawangi Quarry
4	Bricks	22.00	3.105	3741.72 1 brick	1.210 1205.060	Jatwada Village
5	Sand	11.00	5.75	2062.68	358.73	Girija River
6	Murum	3.00	6.00	1319.89	219.98	Local
7	Cement	3.00	10.00	1354.64	135.46	Phulambri
8	Steel	3.00	10.00	1354.64	135.46	Phulambri



**JV STRUCTURAL  
ENGINEERS AND CONSULTANT  
AURANGABAD**

Name of Work :- Construction of Vegetable dehydration processing plant Shed for Parashara Krishi Farmer Producer Company Ltd. at Tq. Phulambri, Dist. Aurangabad.

### TRIAL PIT FOR FOUNDATION

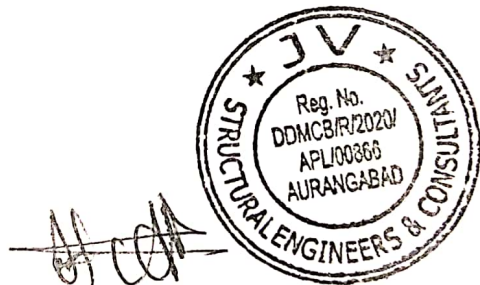
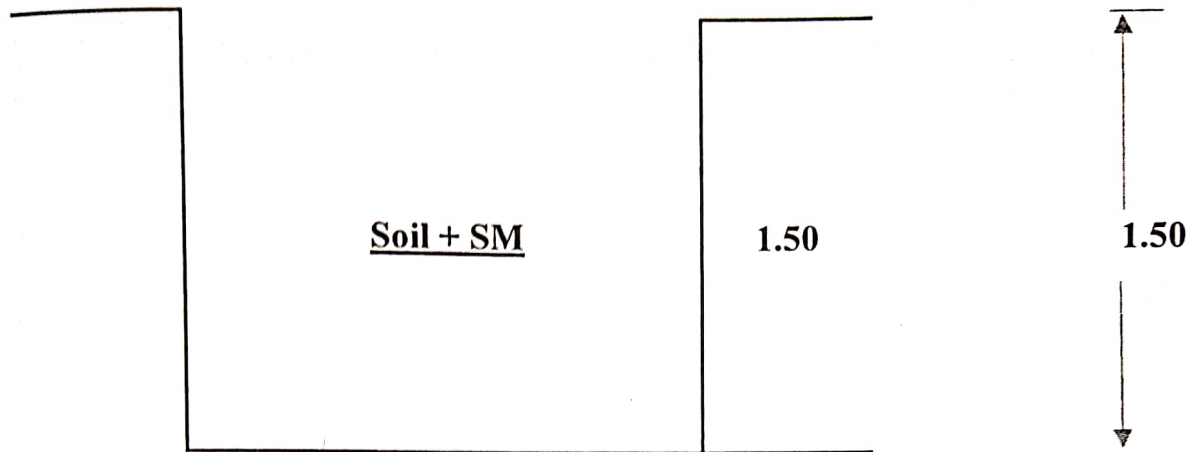

**JV STRUCTURAL  
ENGINEERS AND CONSULTANT  
AURANGABAD**

### SCHEDULE OF COLUMNS

COLUMN NUMBERS	C1, C2, C3, C4, C5, C6, C7, C8, C9, C10 C11, C12, C13, C14, C15, C16, C17, C18 C19, C20, C21, C22, C23, C24, C25, C26 C27, C28, C29, C30, C31, C32, C33, C34 C35, C36
FOOTING TO ROOF SLAB	450 X 750

### SCHEDULE OF STEPPED FOOTINGS

COLUMN NUMBERS	C1, C2, C3, C4, C5, C6, C7, C8, C9, C10 C11, C12, C13, C14, C15, C16, C17, C18 C19, C20, C21, C22, C23, C24, C25, C26 C27, C28, C29, C30, C31, C32, C33, C34 C35, C36	
DEPTH OF FOOTING	Dmax	750
	Dmin	375
SIZE OF FOOTING (B X L)	1ST STEP	1800 X 2500
	2ND STEP	1500 X 2200
SIZE OF P.C.C		1950 X 2650

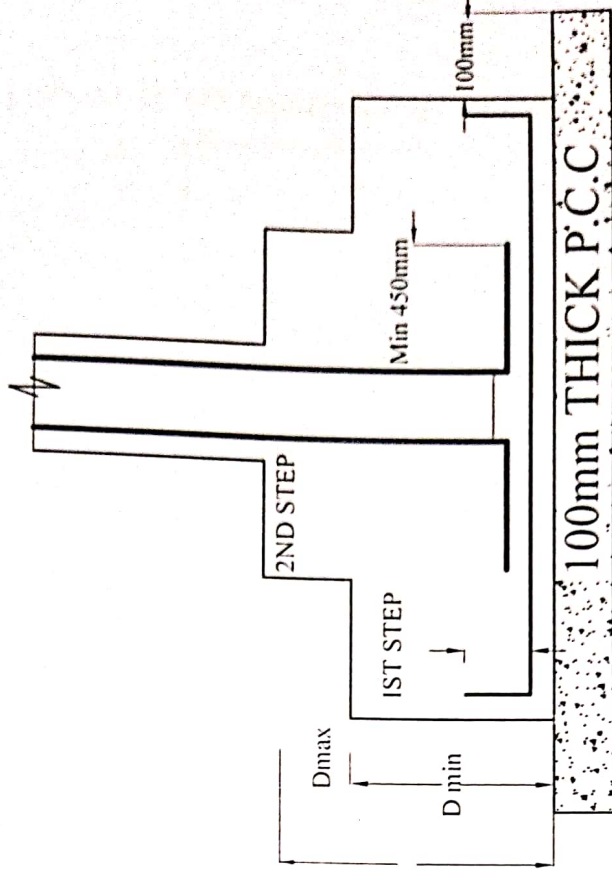

FOUNDATION/COLUMN CENTRE LINE PLAN

NAME OF WORK :- CONSTRUCTION OF WARE HOUSE FOR  
PRASHARA KRISHI FARMER PRODUCER COMPANY LTD. AT  
DHAKAPAL TO PIILAMBRI, DIST. AURANGABAD.

STRUCTURAL DESIGN BY

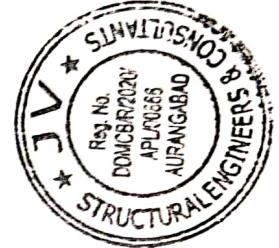

**J.V. Structural Engineers & Consultants**  
OFFICE: Plot 111/1, Pimpri, Pune - 411 004  
Bhosam Nagar, Koteda, Pune - 411 004  
Mobile: 9423028463, 9423021176  
E-mail: jv\_structural@hotmail.com  
J.V. Structural Engineers & Consultants  
PIMPRI, PUNE - 411 004  
DHAKAPAL TO PIILAMBRI, DIST. AURANGABAD  
REG. NO. DOMCBR/2020

EAST

DEVGIRI TO NIGDHONA ROAD

NORTH

9.00 M W I D E R O A D

9.00 M W I D E R O A D

VEGITABLE DEHIDRATON  
PROCESS PLANT  
29.54 X 44.54 M

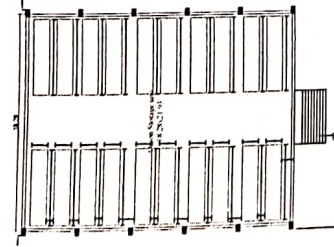
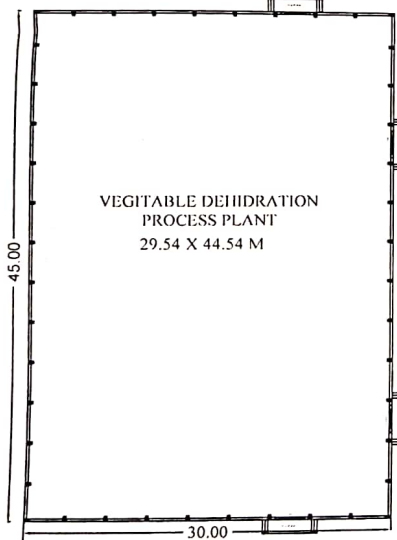

62.01

WEIGHT BRIDGE

W.C. OFFICE CABIN

SOUTH

70.10

WEST

LAYOUT PLAN

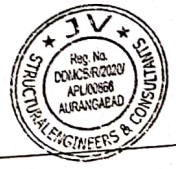

LAYOUT

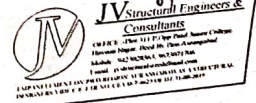

LY FOR ESTIMATE PURPOSE

VEGITABLE SHED

2

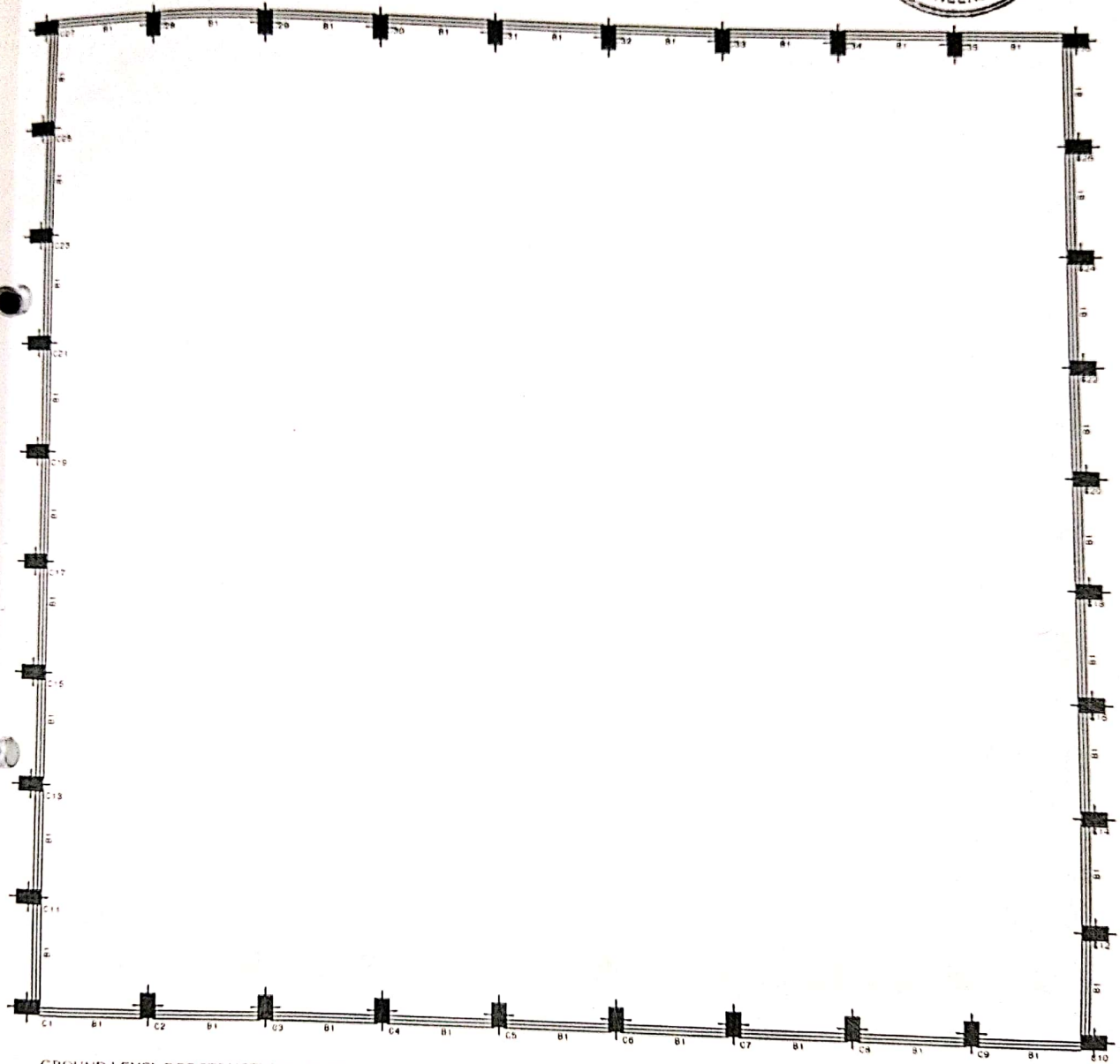

GROUND LEVEL RCC STRUCTURAL PLAN

BEAMS AT GROUND LEVEL  
B1 - 230 X 450

LINTEL LEVEL BEAMS FOR OPENINGS FROM.	
0.00 TO 1.80	-230 X 150
1.80 TO 2.40	-230 X 230
2.40 TO 3.50	-230 X 300
3.50 TO 5.00	-230 X 380

GROUND LEVEL RCC STRUCTURAL PLAN

NAME OF WORK: CONSTRUCTION OF VEGETABLE DELIVERATOR  
PROJECTING PLANT SHED FOR PARAMHARA KRISHNAKAR  
PRODUCE COMPANY LTD AT TQ. HIRI, AURANGABAD

STRUCTURAL DRAWN BY



JV Structural Engineers & Consultants

1982-83 The JV Structural Engineers & Consultants  
Head Office: Plot No. 10, Survey No. 10  
Aurangabad - 431001, Maharashtra  
Branch: Survey No. 10, Plot No. 10  
Aurangabad - 431001, Maharashtra  
E-mail: info@jvce.com, jvce@jvce.com  
CONTACT NUMBER: 9823000000, 9823000000, 9823000000

LY FOR ESTIMATE PURPOSE

VEGITABLE SHED

3

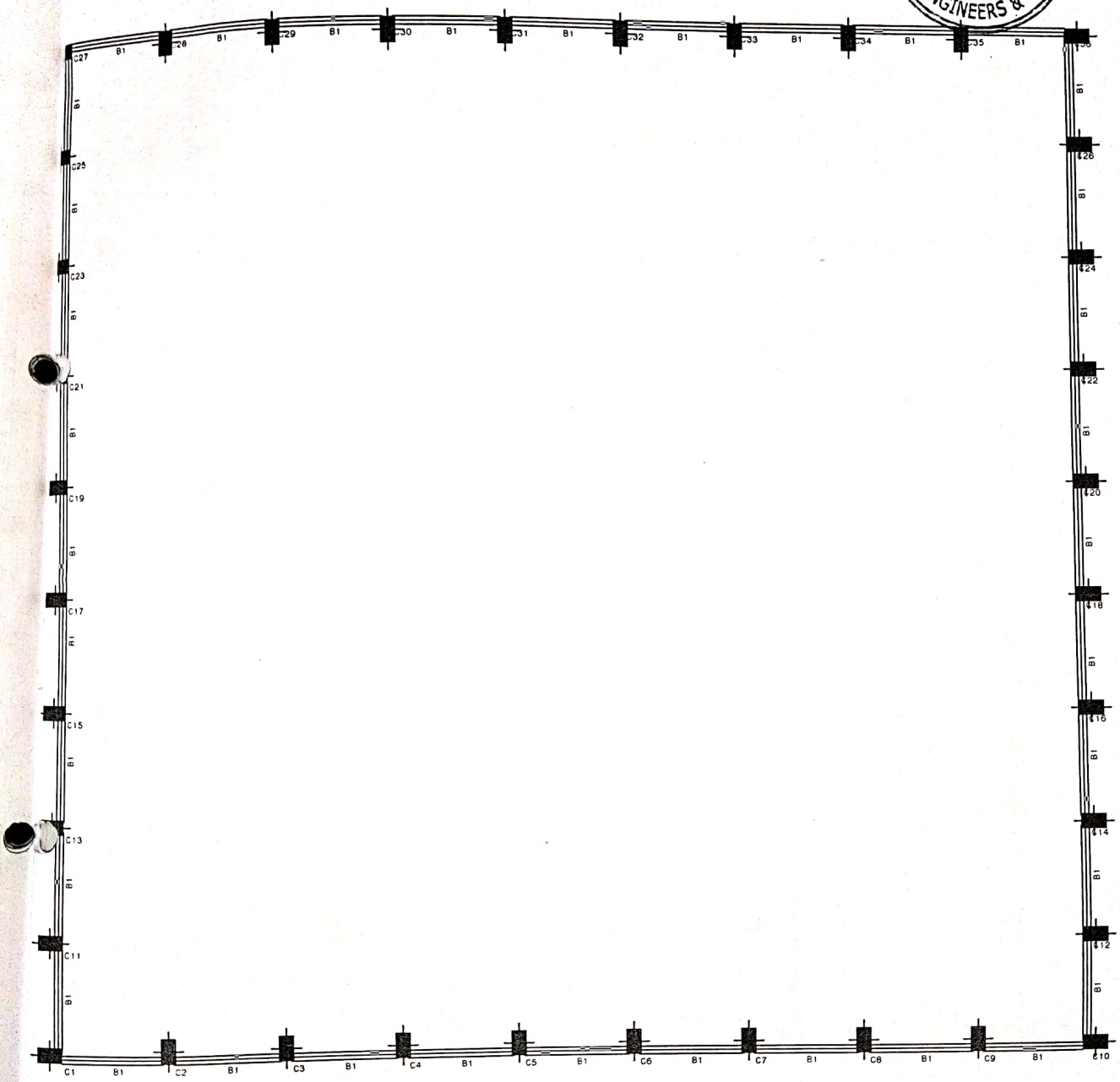

LINTEL LEVEL RCC STRUCTURAL PLAN

LINTEL LEVEL RCC STRUCTURAL PLAN

NAME OF WORK :- CONSTRUCTION OF VEGETABLE DEHYDRATION PROCESSING PLANT SHED FOR PARASHARA KRISHI FARMER PRODUCER COMPANY LTD. AT TQ PHULAMBRI, DIST. AURANGABAD.

STRUCTURAL DESIGN BY

*[Signature]*

**JV Structural Engineers & Consultants**

OFFICE - Plot 311/P. Opp Patel Junior College, Hussain Nagar, Beed B, Pass Aurangabad.  
 Mobile - 9423028503, 9673071716  
 Email - jvstructural@gmail.com

LMPANELMENT ON PWD REGION AURANGABAD AS A STRUCTURAL DESIGNERS VID. CT. 11KNO/CLA-D-74623 OF DT-31-48-2019

BEAMS AT LINTEL LEVEL  
B1 - 230 X 450

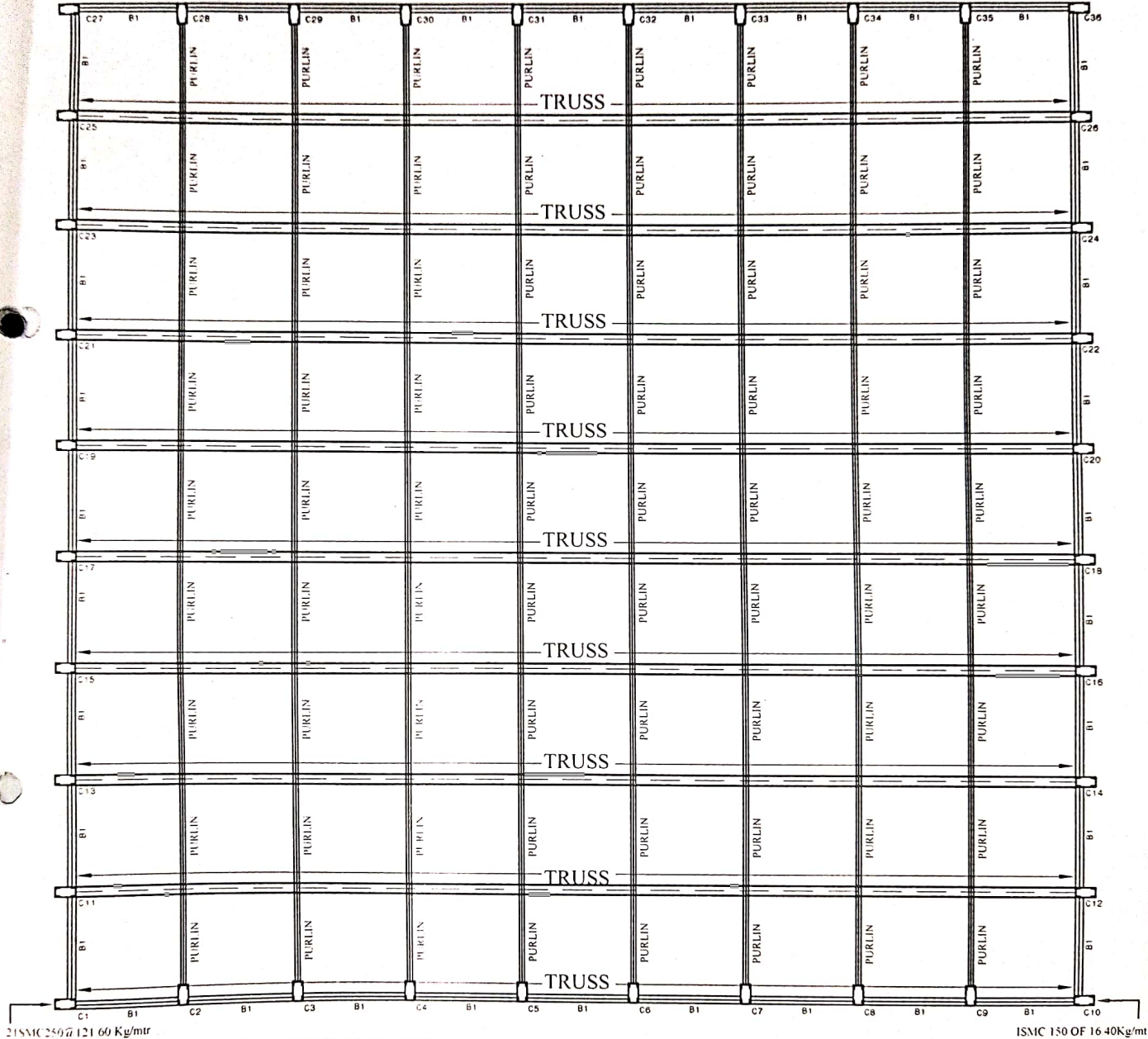

2 ISMC 250 @ 121.60 Kg/mtr

ISMC 150 OF 16.40Kg/mtr

TRUSS BOTTOM LEVEL RCC STRUCTURAL PLAN



BEAMS AT TRUSS BOTT LVL  
B1 - 230 X 450

TRUSS BOTTOM LEVEL RCC STRUCTURAL PLAN

NAME OF WORK - CONSTRUCTION OF VEGETABLE DEHYDRATIC PROCESSING PLANT SHED FOR PARASHARA KRISHI FARMER PRODUCER COMPANY LTD. AT TO PHULAMBRI, DIST. AURANGABAD

STRUCTURAL DESIGN BY



**JV Structural Engineers & Consultants**

OFFICE - Plot 111 Popp Dalvi Jyoti College, Hussen Nagar, Dhad D. Post Aurangabad, Mobile: 9423028543, 9874071296, Email: jvstructural@rediffmail.com

EMPANELMENT ON PWD R.O.P. AT KANGALIBLI AS A STRUCTURAL DESIGNER VIDE C.O. LTR No. CE 15/2022-23 DATED 03/06/2023

